

ASSEMBLY INSTRUCTIONS - DUAL TO SINGLE FLOAT CONVERSION

DIRECT MOUNTED MODEL MP450S / MP550S

Applies to the following installations;

- Tank product is miscible in water.
- Probe lengths exceeding 15 feet.
- Chemical, solvent or heated tanks using standard PVC leader cable.
- Pressurized tanks. Consult with Technical Support for pressure limits.

Questions? Contact Technical Support at (800) 209-7858

FOR INSTALLATION AND WIRING SEE TMS MANUAL

- 1** The top of the probe is an ungageable deadband. Verify that the probe is of sufficient length so that the float's magnet will not travel into this deadband.

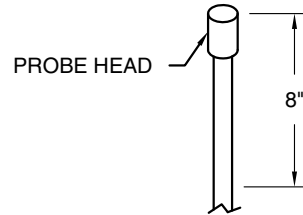

2 4" DIRECT MOUNTING ASSEMBLY

STANDARD APPLICATIONS

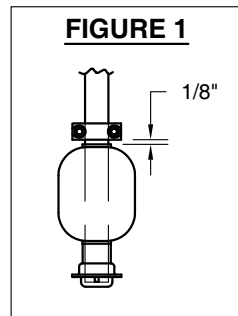
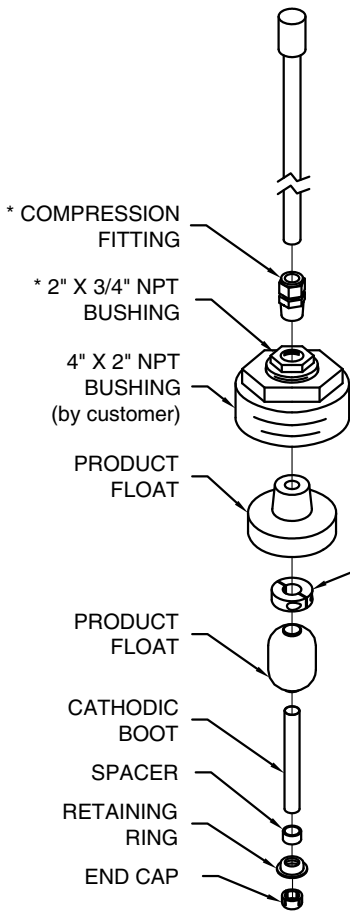

2" DIRECT MOUNTING ASSEMBLY

STANDARD APPLICATIONS

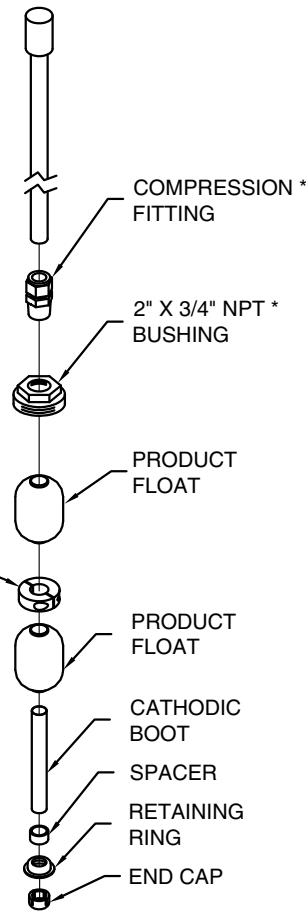

CHEMICAL APPLICATIONS

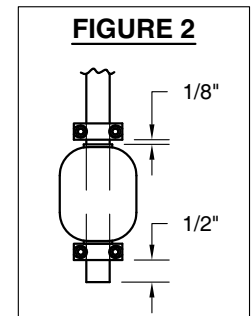
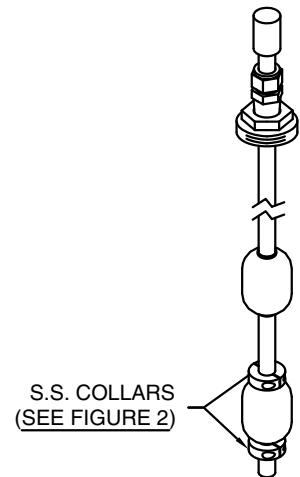

* PURCHASED SEPARATELY FROM PNEUMERCATOR AS MODEL NO. PK2-DMx.
 ** STAINLESS STEEL COLLAR MAY BE SUPPLIED FOR CERTAIN APPLICATIONS.