

CURRENT SWITCH (CS-10)
OUTLINE DRAWING (See wiring diagram on page 2)

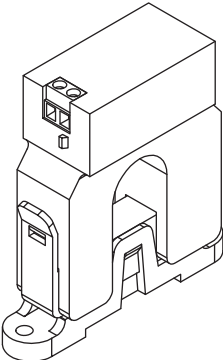

MOUNTING INSTRUCTIONS

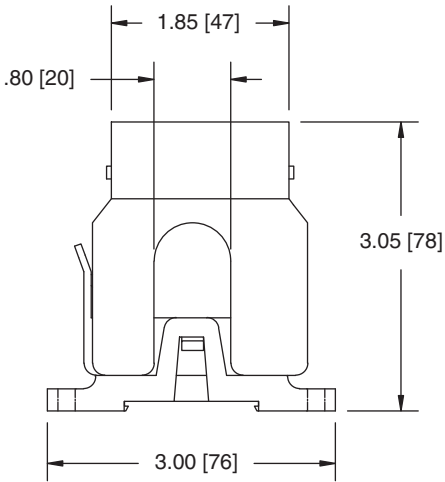
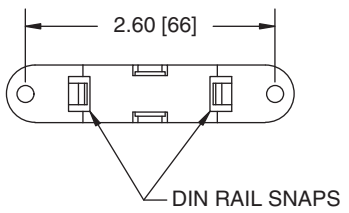

- Ø.18 [5] SCREW MOUNT HOLES
- (OPTIONAL) SNAP MOUNT FOR STANDARD DIN RAIL

NOTES:
1. DRAWING SCALE: 1:1.
2. DIMENSIONS: INCHES [MM].

CURRENT SWITCH (CS-10) WIRING DIAGRAM (See outline drawing on page 1)

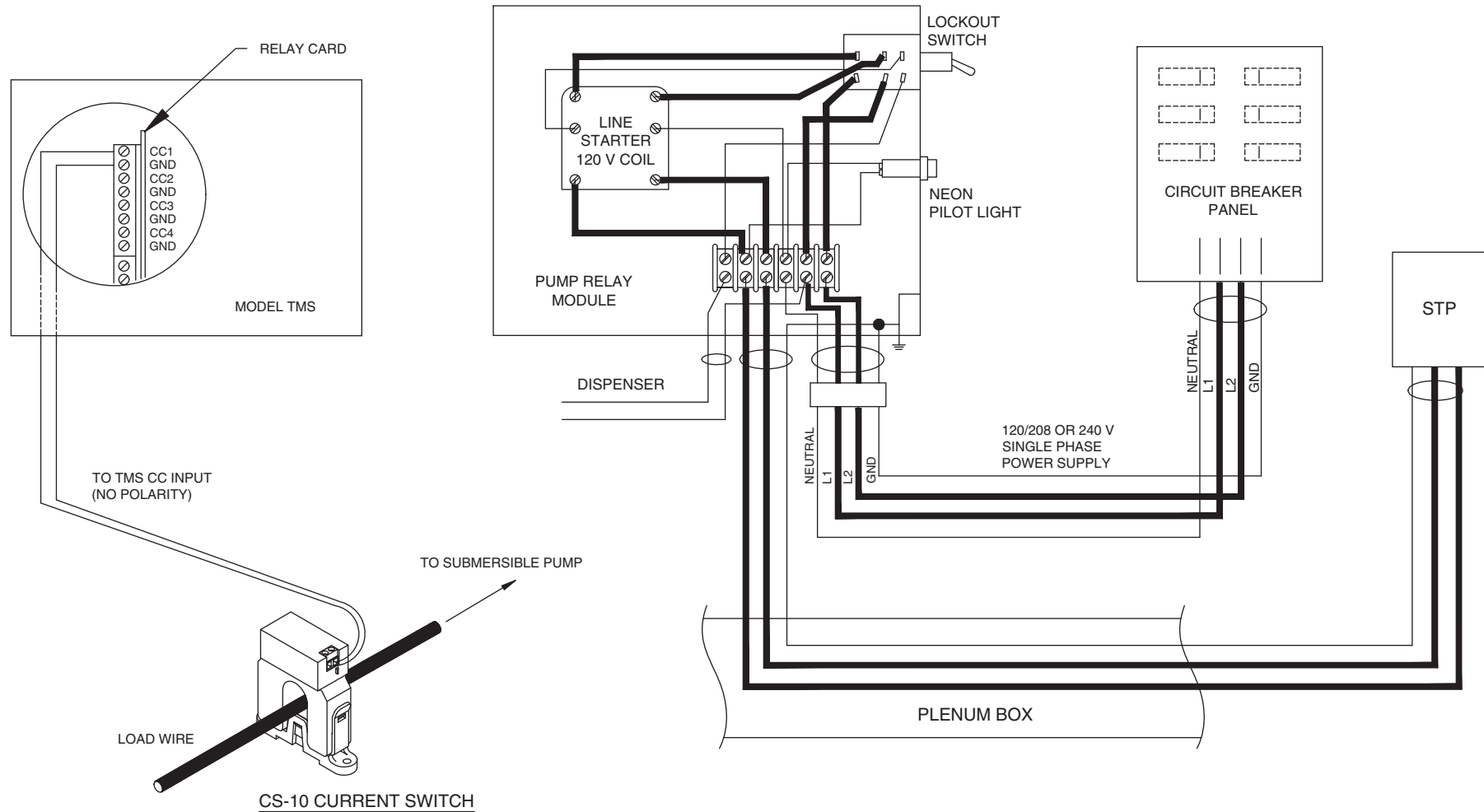

NOTES:

IT IS RECOMMENDED THAT THE CURRENT SWITCH BE LOCATED IN A PLACE SUCH AS THE PLENUM BOX, CIRCUIT BREAKER PANEL OR THE PUMP RELAY MODULE; ALTHOUGH IT CAN BE LOCATED ANYWHERE ALONG THE LOAD WIRE SHOWN AS BOLD BLACK LINES.